

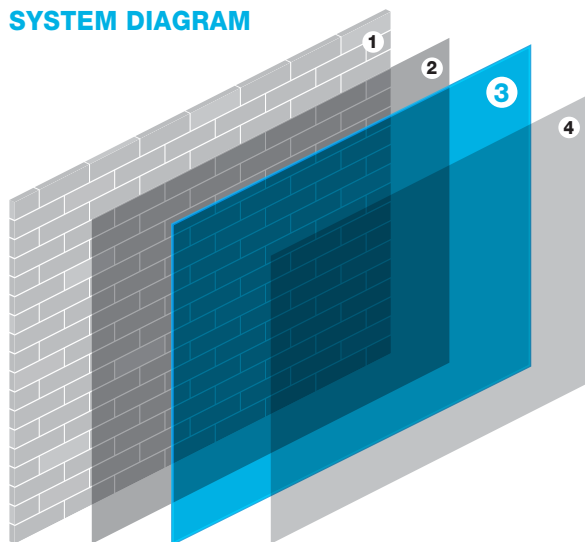

BESSER RENDER 656

High Strength Premium Rendering Coat

SYSTEM DIAGRAM



1. Substrate
2. Waterproofing
3. **Besser Render 656**
4. Paint

DESCRIPTION

Premium smooth plastering for concrete and brick wall for interior and exterior applications

USES

- Exterior and interior plastering

BENEFITS

- Smooth texture rendering
- Thickness up to 12 mm
- Water resistant
- High water retentivity render
- Shrinkage compensated
- Compatible to cementitious waterproofing system

COMPLIED STANDARD

- EN 998, EN 1015
- BS 4551

TECHNICAL PROPERTIES

Technical Properties	Value
Adhesive Strength	> 0.7 N/mm ²
Compressive Strength	> 10 N/mm ²
Water Retentivity	> 97%
Alkaline Resistance	Good

RECOMMENDATION

- Sponge the render surface when the render is 80 - 90% dry which the render is wet but touch dry
- Key coat is recommended for application on smooth concrete surface prior to apply **Besser Render 656**

STORAGE

Shelf life is 6 months if stored in dry and cool place

PACKAGE

Approx. 40kg



BESSER RENDER 656

High Strength Premium Rendering Coat

PHYSICAL FEATURES

Physical Properties	Feature
Water Demand	7.2 – 8.8 L (18 – 22%)
Consumption	1.5 kg/m ² /mm
Binder	Cement, Green Binders
Aggregate Size	1.2 mm
Application Thickness	5 - 12 mm per coat
Pot Life	1 hour

APPLICATION

SUBSTRATE PREPARATION

- Substrate should be free from mould oil, grease, loose particles and contamination of foreign materials
- Dampening of concrete substrate is recommended during hot climate
- Installation of leveling pads or ranks are recommended on substrate if plaster thickness beyond 8 mm
- Key coat is recommended for application on smooth concrete surface

MATERIAL PREPARATION

- Mix 1 bag of 40kg **Besser Render 656** with 7.2 – 8.8 L water for at least 3 minutes by electrical mixer until homogeneous
- Apply 5 – 12 mm thickness in 1 - 2 coat
- Trowel smooth the surface of **Besser Render 656**
- When the render is 80 - 90% dry, rub the render surface with wet sponge to obtain a suitable finishing texture

CURING

- Natural air curing is sufficient
- Recommended to apply water mist curing in first 2 days during hot climate

SAFETY

Wear NIOSH approved facemask during mixing as to avoid inhaling of dust.

May cause irritation to eyes and skin:

1. In case of contact with eyes, rinse immediately with water and seek for medical advice if needed.
2. In case of contact with skin, rinse immediately with soap and water. To seek medical advice if needed.

HEAD OFFICE:

A-1-3A, Pusat Perdagangan Kuchai, No.2, Jalan 1/127,
Off Jalan Kuchai Lama, 58200 Kuala Lumpur, Malaysia.

T: 603-7982 8066 F: 603-7983 8066 W: www.starken.com.my

FACTORY:

Lot 12448-12473, Kawasan Perindustrian Bidor,
Mukim Bidor, Daerah Batang Padang,
35500 Bidor, Perak, Malaysia.